

FAC Propeller Fans



Application

This is a well established range of fans that is both reliable and robust in construction. It provides a cost effective solution for most basic ventilation requirements, ideal for use in workshops, factories, shops, kitchens and agricultural buildings.

Construction

The complete fan assembly is mounted on a rigid pressed metal frame. The impeller consists of a die cast hub with four rigid contoured metal blades, and is dynamically balanced after assembly.

The motor is supported on the mounting plate by four steel arms with rubber mountings.

A motor side guard is fitted as standard.

The highest degree of corrosion resistance is achieved by thorough surface preparation followed by a high quality baked enamel coating. All fasteners are electro-galvanised.

Motors

The motors are totally enclosed airstream rated with power designed to match the respective sizes of impeller and speed.

They are protected to IP44 and fitted with sealed-for-life ball bearings.

The windings have class E insulation suitable for operation in ambient temperatures up to 40°C.

Ancillary equipment

Wall cowls

Impeller Side Wire Guard

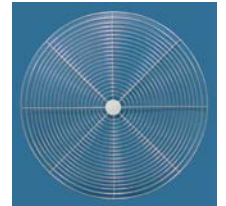

	Model	Fan Size (ømm)	Motor Power (W)	Motor Full Load Amps (A)	Power Supply (Ph/V/Hz)	Fan Speed (RPM)	Sound Level (dBA @ 3m)	Free Air Delivery (m³/s)	Permissible Ambient Temperature Range (°C)	Shipping Mass (kg)	Shipping Dimensions (L x W x Hcm)
Single phase	FAC23/4	230	50	0,21	1/220/50	1400	50	0,22	-20 - +40	5	31 x 31 x 22,5
	FAC30/4	300	130	0,5	1/220/50	1400	53	0,53	-20 - +40	9,8	40 x 40 x 27
	FAC40/4	400	220	0,95	1/220/50	1400	61	1,13	-20 - +40	11,4	49 x 49 x 27,5
	FAC40/6	400	200	0,91	1/220/50	900	56	0,8	-20 - +40	11,4	49 x 49 x 27,5
	FAC45/4	450	380	1,5	1/220/50	1400	65	1,89	-20 - +40	16,9	57 x 57 x 32
	FAC45/6	450	380	0,8	1/220/50	950	56	1,27	-20 - +40	16,9	57 x 57 x 32
	FAC60/4	600	1100	4,1	1/220/50	1400	74	4,44	-20 - +40	26	73 x 73 x 41
	FAC60/6	600	380	1,7	1/220/50	950	64	2,9	-20 - +40	26	73 x 73 x 35
Three phase	FTA38/6	380	100	0,35	3/400/50	910	55	0,69	-20 - +40	8,7	48 x 48 x 34
	FTAC40/4	400	220	0,45	3/400/50	1400	61	1,13	-20 - +40	11,4	49 x 49 x 28
	FTAC45/4	450	380	0,78	3/400/50	1400	65	1,89	-20 - +40	16,9	57 x 57 x 32
	FTAC45/6	450	380	0,55	3/400/50	950	56	1,27	-20 - +40	16,9	57 x 57 x 32
	FTAC60/4	600	1100	2,00	3/400/50	1400	74	4,44	-20 - +40	26	73 x 73 x 41
	FTAC60/6	600	380	0,78	3/400/50	950	64	2,9	-20 - +40	26	73 x 73 x 38
	FTAC75/6	750	1100	2	3/400/50	960	68	5,5	-20 - +40	45	90 x 90 x 41



www.cfw.co.za

Cape Town Head Office: Tel. +27 (0) 21 931 8331 | Johannesburg Tel: +27 (0) 11 452 5830/3/4

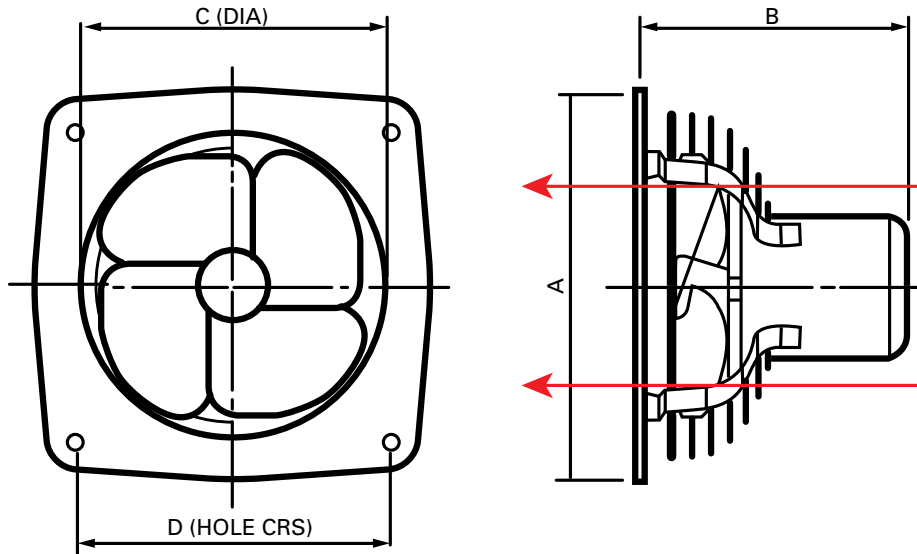

Note: Airflow standard is FORM A.
FORM B available on request.

Dimensions

	Model	A x A	B	C	D x D	Holes	Weather Cowl	Impeller Side Guard
Single phase	FAC23	296	200	230	235	4 x Ø9	WCL400	Ø315
	FAC30	386	240	300	308	4 x Ø9	WCL400	Ø315
	FAC40	482	250	400	380	4 x Ø9	WCL400	Ø400
	FAC45	557	300	450	432	5 x Ø11	WCL500	Ø500
	FAC60	720	405	600	572	5 x Ø13	WCL630	Ø630
Three phase	FTA38/6	472	280	380	368	4 x ø9	WCL400	Ø400
	FTAC40	482	250	400	380	4 x Ø9	WCL400	Ø400
	FTAC45	557	300	450	432	4 x Ø9	WCL500	Ø500
	FTAC60/6	720	405	600	572	5 x Ø11	WCL630	Ø630
	FTAC60/4	720	405	600	572	5 x Ø13	WCL630	Ø630
	FTAC75/6	890	400	750	708	5 x Ø18	WCL710	Ø800

Aerodynamic Performance Data

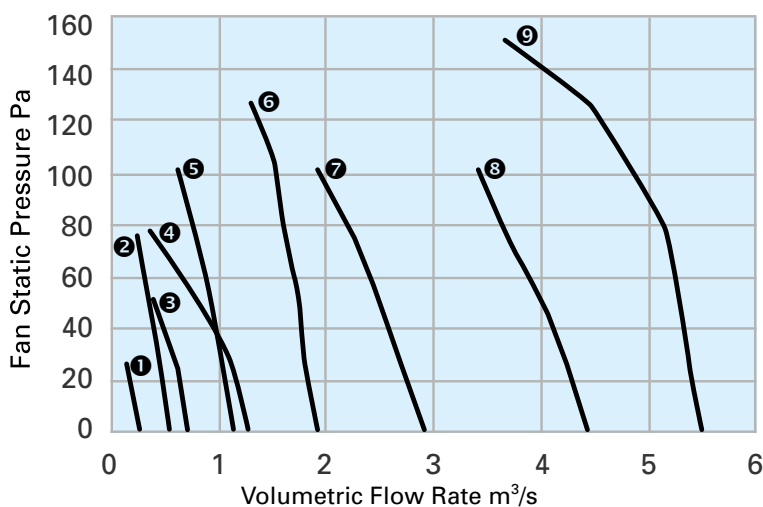

- ❶ FAC23/4
- ❷ FAC30/4
- ❸ FAC38/6
- ❹ FAC40/4
- ❺ FAC45/6
- ❻ FAC45/4
- ❼ FAC60/6
- ❽ FAC60/4
- ❾ FAC75/6



www.cfw.co.za

Cape Town Head Office: Tel. +27 (0) 21 931 8331 | Johannesburg Tel: +27 (0) 11 452 5830/3/4